

Courses down Middle Creek
 East 38 to WOK
 S 58 E 31 to WOK
 69

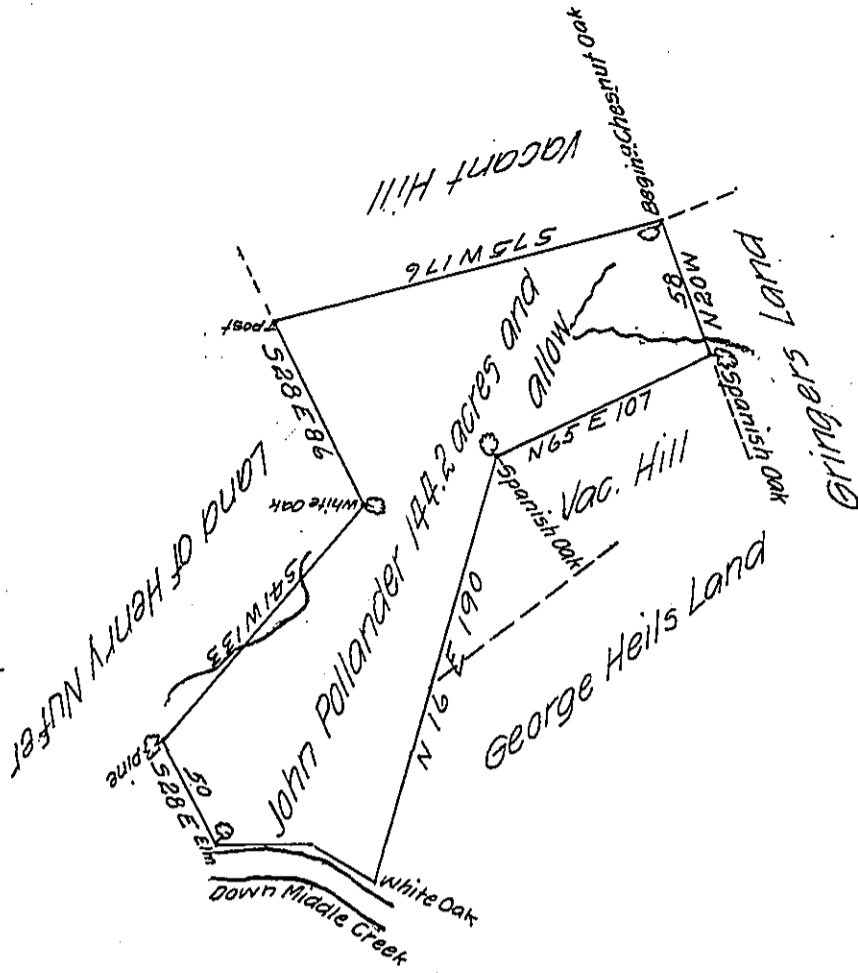

The draught of a tract of land called Poland situate on Middle Creek in the County of Cumberland containing one hundred forty four acres forty nine perches with the usual allowance of six ~~six~~ acres Per cent for roads survey'd for John Pollander the 23^d day of September Anno Dom 1767 in pursuance of an order of survey N^o 2468 bearing date at Philad^a the 11th day of January Anno Dom 1767

To John Lukens Esq. S.G.
 of Pennsylvania

P-W^m MacLay D.S.

IN TESTIMONY that the above is a copy of the original remaining on file in the Department of Internal Affairs of Pennsylvania, made conformably to an Act of Assembly approved the 16th day of February, 1833, I have hereunto set my Hand and caused the Seal of said Department to be affixed at Harrisburg, this seventh day of June 1906

Loael Brown
 Secretary of Internal Affairs.